

PACKSTATION™ FMP

A FULLY MANUAL PACKING STATION ENSURING
THE IDENTIFICATION AND VERIFICATION OF MANUALLY
PACKED PRODUCTS WITH BARCODE SCANNERS



**FAST
SERIES**

OPTEL GROUP's Fast Series products are preconfigured to enable existing pharmaceutical packaging lines to meet compliance, fast. They are the perfect solution to meet tight regulation deadlines — plus, they are easy to operate and require only minimal training. To offer products delivered in matter of weeks, we have expanded our production facilities and developed a streamlined, dedicated manufacturing process specifically for **Fast Series** units.

The **PackStation™ FMP** is a fully manual packing station that ensures the identification and verification of manually packed products with barcode scanners. The **PackStation™ FMP** is designed to record the serial numbers encoded in the GS1 Data Matrix code of the manually packed items (aggregation).

Operated by one or multiple operators, the **PackStation FMP** optimizes the packing process with or without aggregation in order to ensure accurate serialization identification and meet product authentication and traceability requirements in the pharmaceutical industry.

The **PackStation FMP** allows operators to scan children and/or parent labels of any packaging level such as bottles, cartons, bundles, cases or pallets to manually perform the verification of barcode data, as well as the modification of the EPC status for serialization and aggregation requirements without slowing the packing process. Equipped with a dedicated HMI and with complete coder control, the **PackStation FMP** allows operators to manually request the label printing of predetermined packaging levels for manual application, perform rework operations and view serialization data.

INDUSTRIES



BENEFITS

- Easy to install and operate
- Minimal training required
- Simple user interface
- Portable unit

KEY FEATURES

- 21 CFR Part 11 and European Annex 11 compliance
- Carton/bottle to bundle
- Carton/bottle to case
- Case to pallet

The **PackStation™ FMP** is part of OPTEL's open architecture, which greatly facilitates connectivity to various IT systems or other third-party equipment.

OPTEL's **Fast Series** is also designed to be scalable, which will allow you to build on these units in the future, as your serialization operations expand. We understand that modifying your process can be challenging and, to overcome this challenge, we've leveraged all the experience and expertise that comes with nearly 27 years and thousands of successful serialization integration projects around the world.

Our **Fast Series** incorporates all this know-how to provide you with all the necessary features to scale up your serialized production and therefore maintain and generate additional revenues when you're ready.

The **PackStation FMP** is part of OPTEL's **Fast Series** and each product includes hardware and software, IQ/OQ documentation, operator manual, integration and on-site training.

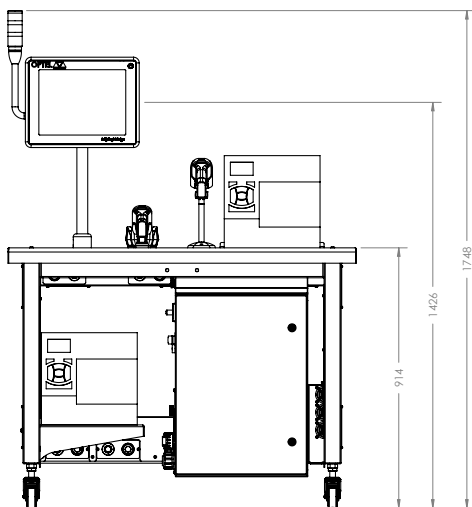

FRONTAL VIEW

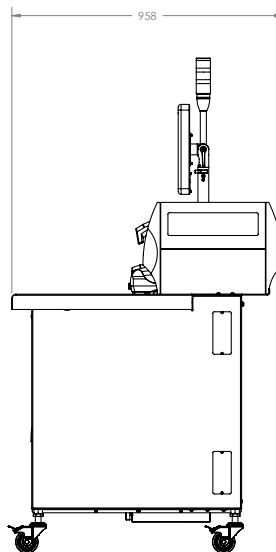

SIDE VIEW

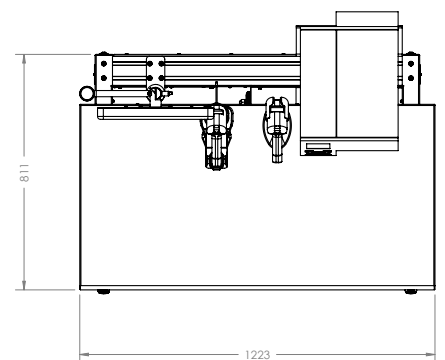

TOP VIEW

PRINTING SPECIFICATIONS

PRINT WIDTH	Up to 152 mm
PRINT TECHNOLOGY	Thermal transfer
PRINTING RESOLUTION	300 DPI
CODER	Zebra

INSPECTION SPECIFICATIONS

DECODING CAPABILITY	1D, 2D
DATA MATRIX MODULE SIZE	0.19 mm
LINEAR BARCODE LINE WIDTH	From 0.1 mm

UTILITIES

POWER REQUIREMENTS	110-120 V 50-60 Hz, 1 phase
	220-240 V 50-60 Hz, 1 phase
TABLE HEIGHT	940 mm + 25 mm (37" ± 1")

BASIC FUNCTIONS

DESIGNED FOR	Bottles, cartons, bundles, cases or pallets
PERFORMS	Serialization and aggregation
REQUIRES	One operator
UPS BATTERY BACKUP	
DELIVERY TIME	10 Weeks

The figures above illustrate an example of a typical installation. OPTTEL has a wide range of solutions to fit the particularities of your specific packaging lines. Contact us for details.

Other modules and options are also available; contact your Regional Sales Representative for more information. Find the location closest to you at: optelgroup.com



OPTTEL is proud to be a **Certified B Corporation**, a group of companies that redefines success in business and strives to not only be the best in the world, but also the best *for* the world.

NORTH AMERICA

OPTTEL Canada — HEADQUARTERS
+1 418 688 0334

NORTH AMERICA

OPTTEL USA
+1 763 235 1400

EUROPE

OPTTEL Ireland
+353 61480965

ASIA

OPTTEL India
+91 832 669 9600

SOUTH AMERICA

OPTTEL Brazil
+55 19 3113 2570

optelgroup.com

© 2018 by OPTTEL GROUP.
All rights reserved.